

SIZING TABLES





INDEX OF SIZING TABLES

Description	Code	Page
AIRCOM FREEZELINE pipe	FRETU	21
Coupling sleeve f/f for gluing	FREMA	21
90° elbow f/f for gluing	FREGO90	22
45° elbow f/f for gluing	FREGO45	22
90° Ti f/f/f for gluing	FRETE	22
Cover f for gluing	FRECA	22
Union f/f for gluing	FREBO	23
Quick branch plug f	FREDER	23
Quick branch plug ,f thread, brass	AIRDERFF	23
Reduced 90° Ti f/f for gluing	FRETR	24
Reduction bushing m/f for gluing	FREBR	24
Flat collar f for gluing	FRECO	25
Free flange	AIRFLPP	25
Through sleeve R. f/f inc. threading	FREMP	25
Through adapter R. m/f inc. threading	FREAP	25
Nipple sleeve f/m/m inc. threading	FREMN	26
90° through elbow f/f	FREGP	26
90° T f/f/f	FRETP	26



AIRCOM FREEZELINE pipe

d	dn	Code	imb	Pn	Spessore	Peso Kg/m	d interno
20	15	FRETU020	80	13	2,1	0,19	15,8
25	20	FRETU025	60	13	2,5	0,3	20
32	25	FRETU032	40	13	3,2	0,49	25,6
40	32	FRETU040	20	13	3,8	0,76	32,4
50	40	FRETU050	16	13	4,9	1,19	40,2
63	50	FRETU063	12	13	5,8	1,9	51,4
75	65	FRETU075	8	13	6,6	2,69	61,8
90	80	FRETU090	4	13	7,7	3,84	74,6
110	100	FRETU110	4	13	9,5	4,86	91

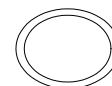

Coupling sleeve f/f for gluing

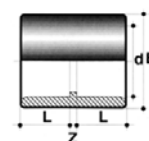
d	dn	Code	imb	L	Z	E	gr
20	15	FREMA020	10	16	3	28	15
25	20	FREMA025	10	19	3	34	23
32	25	FREMA032	10	22	3	42	36
40	32	FREMA040	10	26	3	51	60
50	40	FREMA050	10	31	3	61	85
63	50	FREMA063	5	38	3	75	145
75	65	FREMA075	2	44	4	88	222
90	80	FREMA090	2	51	5	106	353
110	100	FREMA110	2	61	6	129	605

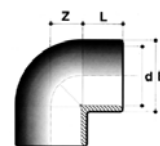

90° elbow f/f for gluing

d	dn	Code	imb	L	Z	E	gr
20	15	FREGO90020	10	16	11	26,5	20
25	20	FREGO90025	10	19	14	32,5	35
32	25	FREGO90032	10	22	17	41	50
40	32	FREGO90040	10	26	23	50	90
50	40	FREGO90050	10	31	28	60	135
63	50	FREGO90063	5	38	34	75	247
75	65	FREGO90075	2	44	40	89	375
90	80	FREGO90090	2	51	48	106	620
110	100	FREGO90110	2	61	58	129	1.060



45° elbow f/f for gluing

d	dn	Code	imb	L	Z	E	gr
20	15	FREGO45020	10	16	5,5	28	17
25	20	FREGO45025	10	19	6	34	30
32	25	FREGO45032	10	22	8	42	47
40	32	FREGO45040	10	26	10	51	77
50	40	FREGO45050	10	31	12	61	115
63	50	FREGO45063	5	38	15	75	190
75	65	FREGO45075	2	44	18	89	310
90	80	FREGO45090	2	51	21	106	485
110	100	FREGO45110	2	61	25	128	835

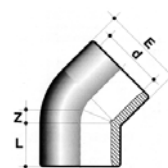

90° Tt f/f for gluing

d	dn	Code	imb	L	Z	E	gr
20	15	FRETE020	10	16	11	27,5	25
25	20	FRETE025	10	19	14	33,5	44
32	25	FRETE032	10	22	17	42	75
40	32	FRETE040	10	26	21	51	120
50	40	FRETE050	10	31	26	61	183
63	50	FRETE063	5	38	33	75	315
75	65	FRETE075	5	44	39	89	495
90	80	FRETE090	5	51	47	106	790
110	100	FRETE110	5	61	57	129	1.330

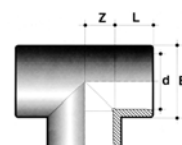

Cover f for gluing

d	dn	Code	imb	L	H	E	gr
20	15	FRECA020	10	16	27	28	10
25	20	FRECA025	10	19	31	33	18
32	25	FRECA032	10	22	36	41	30
40	32	FRECA040	10	26	43	50	45
50	40	FRECA050	10	31	49	60	70
63	50	FRECA063	5	38	57	75	120
75	65	FRECA075	5	44	67	89	178
90	80	FRECA090	5	51	80	106	295
110	100	FRECA110	5	61	92	129	490

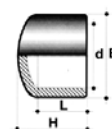

Union f/f for gluing							
d	dn	Code	lmb	L	Z	E	gr
20	15	FREBO020	5	16	13	42	42
25	20	FREBO025	5	19	13	52	70
32	25	FREBO032	5	22	13	59	97
40	32	FREBO040	5	26	15	72	155
50	40	FREBO050	5	31	17	79	216
63	50	FREBO063	5	38	21	96	340
75	65	FREBO075	5	44	21	119	580

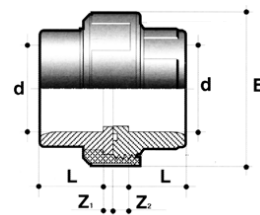

Quick branch plug f							
d	Code	lmb	E1	E2	H1	H2	gr
25X20	FREDER025020	5					
32X20	FREDER032020	5					
40X20	FREDER040020	5					
40x25	FREDER040025	5					
50x20	FREDER050020	5					
50x25	FREDER050025	5					
63x20	FREDER063020	5					
63x25	FREDER063025	5					
63x32	FREDER063032	5					

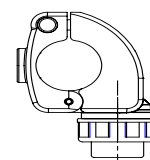

Quick branch plug ,f thread, brass							
d	Code	lmb	E1	E2	H1	H2	gr
25x1/2"	AIRDERFF025048	5					
32x1/2"	AIRDERFF032048	5					
40x1/2"	AIRDERFF040048	5					
40x3/4"	AIRDERFF040068	5					
50x1/2"	AIRDERFF050048	5					
50x3/4"	AIRDERFF050068	5					
63x1/2"	AIRDERFF063048	5					
63x3/4"	AIRDERFF063068	5					
63x1"	AIRDERFF063088	5					

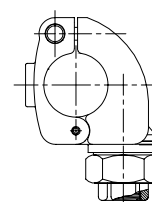

Reduced 90° Ti f/f for gluing										
dxd1	dn	Code	imb	L	L1	Z	Z1	E	E1	gr
25x20	20x15	FRETR025020	10	19	16	14	14	33,5	28	42
32x20	25x15	FRETR032020	10	22	16	17	17	42	28	69
32x25	25x20	FRETR032025	10	22	19	17	17	42	34	70
40x20	32x15	FRETR040020	10	26	16	21	21	51	38	112
40x25	32x20	FRETR040025	10	26	19	21	21	51	34	115
50x20	40x15	FRETR050020	10	31	16	26	26	61	28	155
50x25	40x20	FRETR050025	10	31	19	26	26	61	34	166
50x32	40x25	FRETR050032	10	31	22	26	26	61	42	170
63x20	50x15	FRETR063020	5	38	16	33	33	75	28	268
63x25	50x20	FRETR063025	5	38	19	33	33	75	34	270
63x32	50x25	FRETR063032	5	38	22	33	33	75	42	275
75x32	65x25	FRETR075032	2	44	22	39	39	89	42	463
90x40	80x32	FRETR090040	2	51	26	47	47	106	51	702
110x50	100x40	FRETR110050	2	61	31	57	57	129	61	1250

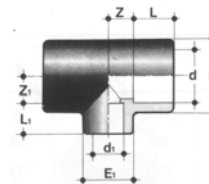

Reduction bushing m/f for gluing							
d	dn	Code	imb	L	L1	ZZ1	gr
25x20	20x15	FREBR025020	10	19	16	3	6
32x20	25x15	FREBR032020	10	22	16	6	15
32x25	25x20	FREBR032025	10	22	19	3	10
40x20	32x15	FREBR040020	10	26	16	10	29
40x25	32x20	FREBR040025	10	26	19	7	28
40x32	32x25	FREBR040032	10	26	22	4	19
50x25	40x20	FREBR050025	10	31	19	12	45
50x32	40x25	FREBR050032	10	31	22	9	45
50x40	40x32	FREBR050040	10	31	26	5	35
63x32	50x25	FREBR063032	10	38	22	16	83
63x40	50x32	FREBR063040	10	38	26	12	83
63x50	50x40	FREBR063050	5	38	31	7	61
75x40	65x32	FREBR075040	5	44	26	18	125
75x50	65x40	FREBR075050	5	44	31	13	122
75x63	65x50	FREBR075063	5	44	38	6	85
90x50	80x40	FREBR090050	2	51	31	20	210
90x63	80x50	FREBR090063	2	51	38	13	180
90x75	80x65	FREBR090075	2	51	44	7	140
110x63	100x50	FREBR110063	2	61	38	23	372
110x75	100x65	FREBR110075	2	61	44	17	335
110x90	100x80	FREBR110090	2	61	51	10	262

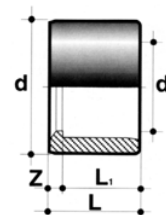

Flat collar f for gluing

d	dn	Code	imb	L	Z	S	E	E ₁	gr
50	40	FRECO050	6	31	3	8	61	73	60
63	50	FRECO063	6	38	3	9	76	90	113
75	65	FRECO075	2	44	3	10	90	106	160
90	80	FRECO090	2	51	5	11	108	125	263
110	100	FRECO110	2	61	5	12	131	150	420

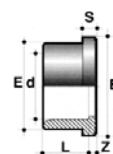
Free flange

d	dn	Code	imb	D	E	S	I	F	n.fori	Bulloni	gr
50	40	AIRFLPP050	6	62	152	16	110	18	4	M16x75	230
63	50	AIRFLPP063	6	78	165	18	125	18	4	M16x80	280
75	65	AIRFLPP075	2	92	185	19	145	18	4	M16x90	355
90	80	AIRFLPP090	2	110	200	20	160	18	8	M16x90	430
110	100	AIRFLPP110	2	133	220	22	180	18	8	M16x100	520

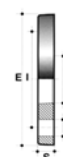
Through sleeve R. f/f inc. threading

dxG	Code	imb	L	L ₁	Z	E	E ₁	gr
20x1/2"	FREMP020048	10	16	15	4	28	29	23
25x3/4"	FREMP025068	10	19	16,3	6	34	35	32
32x1"	FREMP032088	10	22	19,1	6	42	43	47
40x1.1/4"	FREMP040108	10	26	21,4	8	50,5	51,5	78
50x1.1/2"	FREMP050128	10	31	21,4	13	61	62	107
63x2"	FREMP063168	5	38	25,7	15	75	76	180

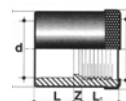
Through adapter R. m/f inc. threading

dxG	Code	imb	L	L ₁	E	Z	C	gr
20x1/2"	FREAP020048	10	16	15	29	24	30	25
25x3/4"	FREAP025068	10	19	16,3	35	27	36	32
32x1"	FREAP032088	10	22	19,1	43	30	46	52
40x1.1/4"	FREAP040108	10	26	21,4	51,5	36	55	75
50x1.1/2"	FREAP050128	10	31	21,4	61	41	60	92
63x2"	FREAP063168	5	38	25,7	76	48	75	150

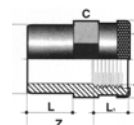

Nipple sleeve f/m/m inc. threading								
dxG	Code	imb	L	L1	L2	H	C	gr
16x20x1/2"	FREMNO16048	10	14	14	11,4	40	24	10
20x25x1/2"	FREMNO20048	10	16	16	15	46	27	15
20x25x3/4"	FREMNO20068	10	16	16	15	46	27	16
25x32x3/4"	FREMNO25068	10	19	19	16,3	50	36	26
25x32x1"	FREMNO25088	19	19	19	16,3	50	36	28
32x40x1"	FREMNO32088	10	22	26	19,1	57	42	40
32x40x1.1/4"	FREMNO32108	10	22	26	19,1	57	42	45
40x50x1.1/4"	FREMNO40108	10	26	31	21,4	66,5	55	75
40x50x1.1/2"	FREMNO40128	10	26	31	21,4	66,5	55	80
50x63x1.1/2"	FREMNO50128	10	31	38	21,4	74	65	113
50x63x2"	FREMNO50168	10	31	38	21,4	74	65	120
63x75x2"	FREMNO63168	5	38	44	25,7	84	75	150
63x75x2.1/2"	FREMNO63208	5	38	44	26	84	75	160
75x90x2.1/2"	FREMNO75208	5	44	51	30,2	99	95	270

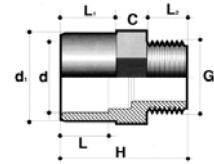

90° through elbow f/f								
dxG	Code	imb	L	L1	Z	Z1	E	gr
20x1/2"	FREGP020048	10	16	15	11	46	26,5	15
25x3/4"	FREGP025068	10	19	16,3	14	50	32,5	27
32x1"	FREGP032088	10	22	19,1	17	57	41	48

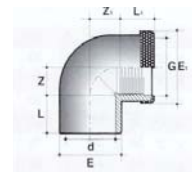

90° T f/f/f								
dxG	Code	imb	L	L1	Z	Z1	E	gr
20x1/2"	FRETP020048	10	16	15	11	12	27,5	25
25x3/4"	FRETP025068	10	19	16,3	14	16,7	33,5	38
32x1"	FRETP032088	10	22	19,1	17	19,9	42	69

